

Spacers

Steel / Stainless Steel

SPECIFICATION

Types

- Type **A**: Internal thread
- Type **B**: Internal thread and threaded stud

Steel **ST**

Zinc plated, blue passivated

Stainless Steel **AISI 303 NI**

Matte shot-blasted

INFORMATION

Spacers GN 6220 are commonly used as spacing rods. They allow parts to be fastened with an offset parallel to their mounting plane. Type A is also used as a connecting nut.

TECHNICAL INFORMATION

- Stainless Steel Characteristics (see page A26)



Type A

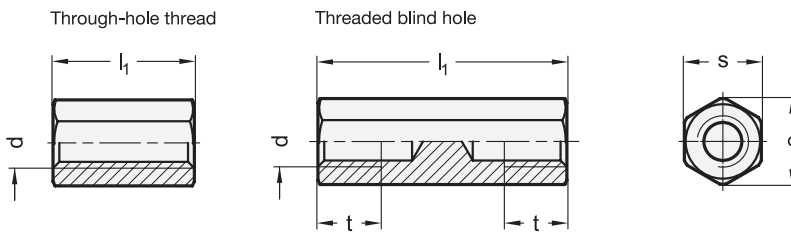

Type B

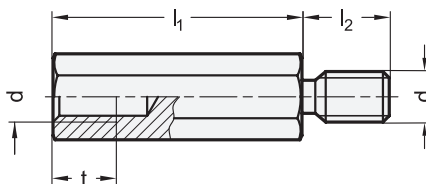

Application example

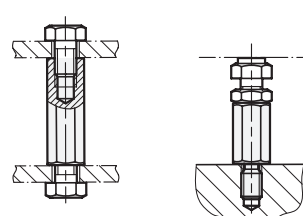

Type A

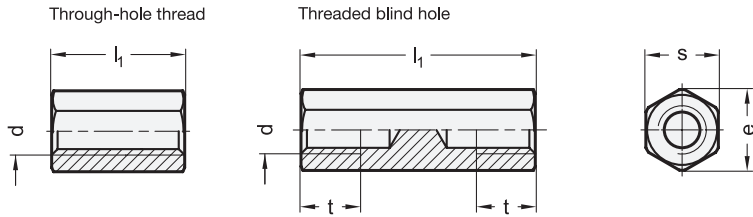

Type B

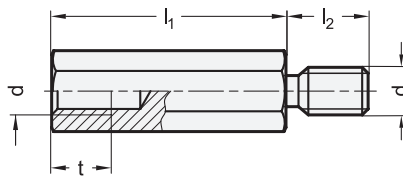

Application example

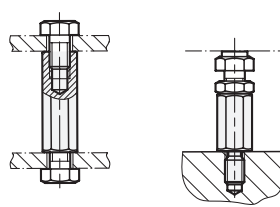

GN 6220-ST

Description	d	li ±0.1 Through-hole thread	li ±0.1 Threaded blind hole	li ±0.1	e ≈	l2	s	t min.	⚖
GN 6220-ST-M2.5-5-A	M 2.5	5	-	-	5.8	-	5	7	1
GN 6220-ST-M2.5-8-A	M 2.5	8	-	-	5.8	-	5	7	1
GN 6220-ST-M2.5-10-A	M 2.5	10	-	-	5.8	-	5	7	1
GN 6220-ST-M2.5-12-A	M 2.5	12	-	-	5.8	-	5	7	2
GN 6220-ST-M2.5-15-A	M 2.5	-	15	-	5.8	-	5	7	2
GN 6220-ST-M2.5-20-A	M 2.5	-	20	-	5.8	-	5	7	3
GN 6220-ST-M2.5-25-A	M 2.5	-	25	-	5.8	-	5	7	3
GN 6220-ST-M2.5-30-A	M 2.5	-	30	-	5.8	-	5	7	4
GN 6220-ST-M3-8-A	M 3	8	-	-	6.4	-	5.5	7	1
GN 6220-ST-M3-10-A	M 3	10	-	-	6.4	-	5.5	7	2
GN 6220-ST-M3-12-A	M 3	12	-	-	6.4	-	5.5	7	2
GN 6220-ST-M3-15-A	M 3	-	15	-	6.4	-	5.5	7	2
GN 6220-ST-M3-20-A	M 3	-	20	-	6.4	-	5.5	7	3
GN 6220-ST-M3-25-A	M 3	-	25	-	6.4	-	5.5	7	4
GN 6220-ST-M3-30-A	M 3	-	30	-	6.4	-	5.5	7	5
GN 6220-ST-M3-35-A	M 3	-	35	-	6.4	-	5.5	7	6
GN 6220-ST-M3-40-A	M 3	-	40	-	6.4	-	5.5	7	7
GN 6220-ST-M3-45-A	M 3	-	45	-	6.4	-	5.5	7	8
GN 6220-ST-M3-50-A	M 3	-	50	-	6.4	-	5.5	7	9
GN 6220-ST-M4-10-A	M 4	10	-	-	8	-	7	9	4
GN 6220-ST-M4-12-A	M 4	12	-	-	8	-	7	9	6
GN 6220-ST-M4-15-A	M 4	15	-	-	8	-	7	9	4
GN 6220-ST-M4-20-A	M 4	-	20	-	8	-	7	9	8
GN 6220-ST-M4-25-A	M 4	-	25	-	8	-	7	9	10
GN 6220-ST-M4-30-A	M 4	-	30	-	8	-	7	9	10
GN 6220-ST-M4-35-A	M 4	-	35	-	8	-	7	9	8
GN 6220-ST-M4-40-A	M 4	-	40	-	8	-	7	9	12
GN 6220-ST-M4-45-A	M 4	-	45	-	8	-	7	9	14
GN 6220-ST-M4-50-A	M 4	-	50	-	8	-	7	9	14
GN 6220-ST-M4-60-A	M 4	-	60	-	8	-	7	9	18
GN 6220-ST-M4-70-A	M 4	-	70	-	8	-	7	9	22
GN 6220-ST-M4-80-A	M 4	-	80	-	8	-	7	9	24
GN 6220-ST-M5-20-A	M 5	-	20	-	9.2	-	8	10	8
GN 6220-ST-M5-25-A	M 5	-	25	-	9.2	-	8	10	8
GN 6220-ST-M5-30-A	M 5	-	30	-	9.2	-	8	10	14
GN 6220-ST-M5-35-A	M 5	-	35	-	9.2	-	8	10	12
GN 6220-ST-M5-40-A	M 5	-	40	-	9.2	-	8	10	16
GN 6220-ST-M5-45-A	M 5	-	45	-	9.2	-	8	10	18
GN 6220-ST-M5-50-A	M 5	-	50	-	9.2	-	8	10	18
GN 6220-ST-M5-60-A	M 5	-	60	-	9.2	-	8	10	24

Description	d	li ±0.1 Through-hole thread	li ±0.1 Threaded blind hole	li ±0.1	e ≈	l2	s	t min.	⚖
GN 6220-ST-M5-70-A	M 5	-	70	-	9.2	-	8	10	28
GN 6220-ST-M5-80-A	M 5	-	80	-	9.2	-	8	10	32
GN 6220-ST-M5-12-A	M 5	12	-	-	9.2	-	8	10	6
GN 6220-ST-M5-15-A	M 5	15	-	-	9.2	-	8	10	4
GN 6220-ST-M6-12-A	M 6	12	-	-	11.5	-	10	12	8
GN 6220-ST-M6-15-A	M 6	15	-	-	11.5	-	10	12	6
GN 6220-ST-M6-20-A	M 6	-	20	-	11.5	-	10	10	8
GN 6220-ST-M6-25-A	M 6	-	25	-	11.5	-	10	10	16
GN 6220-ST-M6-30-A	M 6	-	30	-	11.5	-	10	12	16
GN 6220-ST-M6-35-A	M 6	-	35	-	11.5	-	10	12	18
GN 6220-ST-M6-40-A	M 6	-	40	-	11.5	-	10	12	24
GN 6220-ST-M6-45-A	M 6	-	45	-	11.5	-	10	12	24
GN 6220-ST-M6-50-A	M 6	-	50	-	11.5	-	10	12	28
GN 6220-ST-M6-60-A	M 6	-	60	-	11.5	-	10	12	36
GN 6220-ST-M6-70-A	M 6	-	70	-	11.5	-	10	12	40
GN 6220-ST-M6-80-A	M 6	-	80	-	11.5	-	10	12	48
GN 6220-ST-M8-15-A	M 8	15	-	-	15	-	13	14	14
GN 6220-ST-M8-20-A	M 8	20	-	-	15	-	13	14	20
GN 6220-ST-M8-25-A	M 8	-	25	-	15	-	13	12	22
GN 6220-ST-M8-30-A	M 8	-	30	-	15	-	13	14	28
GN 6220-ST-M8-35-A	M 8	-	35	-	15	-	13	14	30
GN 6220-ST-M8-40-A	M 8	-	40	-	15	-	13	14	36
GN 6220-ST-M8-45-A	M 8	-	45	-	15	-	13	14	40
GN 6220-ST-M8-50-A	M 8	-	50	-	15	-	13	14	46
GN 6220-ST-M8-60-A	M 8	-	60	-	15	-	13	14	58
GN 6220-ST-M8-70-A	M 8	-	70	-	15	-	13	14	72
GN 6220-ST-M8-80-A	M 8	-	80	-	15	-	13	14	80
GN 6220-ST-M10-25-A	M 10	25	-	-	19.5	-	17	16	34
GN 6220-ST-M10-30-A	M 10	30	-	-	19.5	-	17	16	42
GN 6220-ST-M10-35-A	M 10	-	35	-	19.5	-	17	16	49
GN 6220-ST-M10-40-A	M 10	-	40	-	19.5	-	17	16	56
GN 6220-ST-M10-45-A	M 10	-	45	-	19.5	-	17	16	62
GN 6220-ST-M10-50-A	M 10	-	50	-	19.5	-	17	16	71
GN 6220-ST-M10-60-A	M 10	-	60	-	19.5	-	17	16	91
GN 6220-ST-M10-70-A	M 10	-	70	-	19.5	-	17	16	110
GN 6220-ST-M10-80-A	M 10	-	80	-	19.5	-	17	16	130
GN 6220-ST-M10-100-A	M 10	-	100	-	19.5	-	17	16	167



Type A

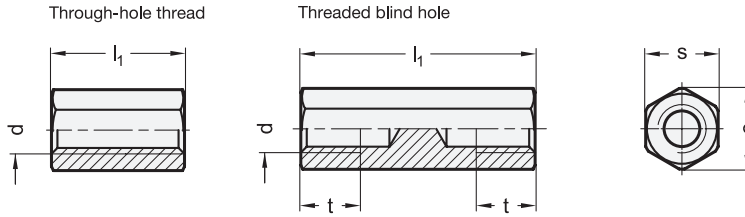

Type B

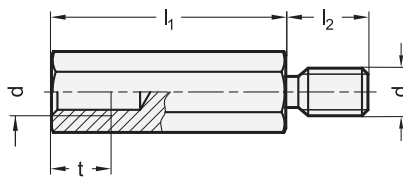

Application example

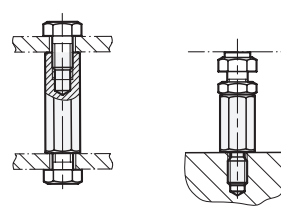

GN 6220-ST

Description	d	l1 ±0.1 Through-hole thread	l1 ±0.1 Threaded blind hole	l1 ±0.1	e ≈	l2	s	t min.	Δ
GN 6220-ST-M2,5-8-B	M 2.5	-	-	8	5.8	6	5	5	1
GN 6220-ST-M2,5-10-B	M 2.5	-	-	10	5.8	6	5	5	2
GN 6220-ST-M2,5-12-B	M 2.5	-	-	12	5.8	6	5	7	2
GN 6220-ST-M2,5-15-B	M 2.5	-	-	15	5.8	6	5	7	2
GN 6220-ST-M2,5-20-B	M 2.5	-	-	20	5.8	6	5	7	3
GN 6220-ST-M2,5-25-B	M 2.5	-	-	25	5.8	6	5	7	4
GN 6220-ST-M2,5-30-B	M 2.5	-	-	30	5.8	6	5	7	5
GN 6220-ST-M3-8-B	M 3	-	-	8	6.4	6	5.5	5	2
GN 6220-ST-M3-10-B	M 3	-	-	10	6.4	6	5.5	5	2
GN 6220-ST-M3-12-B	M 3	-	-	12	6.4	6	5.5	7	2
GN 6220-ST-M3-15-B	M 3	-	-	15	6.4	6	5.5	7	3
GN 6220-ST-M3-20-B	M 3	-	-	20	6.4	6	5.5	7	4
GN 6220-ST-M3-25-B	M 3	-	-	25	6.4	6	5.5	7	5
GN 6220-ST-M3-30-B	M 3	-	-	30	6.4	6	5.5	7	6
GN 6220-ST-M3-35-B	M 3	-	-	35	6.4	6	5.5	7	7
GN 6220-ST-M3-40-B	M 3	-	-	40	6.4	6	5.5	7	8
GN 6220-ST-M3-45-B	M 3	-	-	45	6.4	6	5.5	7	9
GN 6220-ST-M3-50-B	M 3	-	-	50	6.4	6	5.5	7	10
GN 6220-ST-M4-10-B	M 4	-	-	10	8	8	7	5	4
GN 6220-ST-M4-12-B	M 4	-	-	12	8	8	7	7	6
GN 6220-ST-M4-15-B	M 4	-	-	15	8	8	7	9	6
GN 6220-ST-M4-20-B	M 4	-	-	20	8	8	7	9	6
GN 6220-ST-M4-25-B	M 4	-	-	25	8	8	7	9	10
GN 6220-ST-M4-30-B	M 4	-	-	30	8	8	7	9	10
GN 6220-ST-M4-35-B	M 4	-	-	35	8	8	7	9	14
GN 6220-ST-M4-40-B	M 4	-	-	40	8	8	7	9	14
GN 6220-ST-M4-45-B	M 4	-	-	45	8	8	7	9	16
GN 6220-ST-M4-50-B	M 4	-	-	50	8	8	7	9	18
GN 6220-ST-M4-60-B	M 4	-	-	60	8	8	7	9	20
GN 6220-ST-M4-70-B	M 4	-	-	70	8	8	7	9	24
GN 6220-ST-M4-80-B	M 4	-	-	80	8	8	7	9	26
GN 6220-ST-M5-12-B	M 5	-	-	12	9.2	8	8	7	6
GN 6220-ST-M5-15-B	M 5	-	-	15	9.2	8	8	10	8
GN 6220-ST-M5-20-B	M 5	-	-	20	9.2	8	8	10	8
GN 6220-ST-M5-25-B	M 5	-	-	25	9.2	8	8	10	14
GN 6220-ST-M5-30-B	M 5	-	-	30	9.2	8	8	10	14
GN 6220-ST-M5-35-B	M 5	-	-	35	9.2	8	8	10	16
GN 6220-ST-M5-40-B	M 5	-	-	40	9.2	8	8	10	16
GN 6220-ST-M5-45-B	M 5	-	-	45	9.2	8	8	10	20
GN 6220-ST-M5-50-B	M 5	-	-	50	9.2	8	8	10	22

Description	d	l1 ±0.1 Through-hole thread	l1 ±0.1 Threaded blind hole	l1 ±0.1	e ≈	l2	s	t min.	Δ
GN 6220-ST-M5-60-B	M 5	-	-	60	9.2	8	8	10	24
GN 6220-ST-M5-70-B	M 5	-	-	70	9.2	8	8	10	32
GN 6220-ST-M5-80-B	M 5	-	-	80	9.2	8	8	10	34
GN 6220-ST-M6-15-B	M 6	-	-	15	11.5	10	10	10	10
GN 6220-ST-M6-20-B	M 6	-	-	20	11.5	10	10	12	14
GN 6220-ST-M6-25-B	M 6	-	-	25	11.5	10	10	12	18
GN 6220-ST-M6-30-B	M 6	-	-	30	11.5	10	10	12	20
GN 6220-ST-M6-35-B	M 6	-	-	35	11.5	10	10	12	22
GN 6220-ST-M6-40-B	M 6	-	-	40	11.5	10	10	12	24
GN 6220-ST-M6-45-B	M 6	-	-	45	11.5	10	10	12	28
GN 6220-ST-M6-50-B	M 6	-	-	50	11.5	10	10	12	32
GN 6220-ST-M6-60-B	M 6	-	-	60	11.5	10	10	12	42
GN 6220-ST-M6-70-B	M 6	-	-	70	11.5	10	10	12	42
GN 6220-ST-M6-80-B	M 6	-	-	80	11.5	10	10	12	52
GN 6220-ST-M8-20-B	M 8	-	-	20	15	14	13	14	24
GN 6220-ST-M8-25-B	M 8	-	-	25	15	14	13	14	30
GN 6220-ST-M8-30-B	M 8	-	-	30	15	14	13	14	34
GN 6220-ST-M8-35-B	M 8	-	-	35	15	14	13	14	40
GN 6220-ST-M8-40-B	M 8	-	-	40	15	14	13	14	46
GN 6220-ST-M8-45-B	M 8	-	-	45	15	14	13	14	50
GN 6220-ST-M8-50-B	M 8	-	-	50	15	14	13	14	60
GN 6220-ST-M8-60-B	M 8	-	-	60	15	14	13	14	68
GN 6220-ST-M8-70-B	M 8	-	-	70	15	14	13	14	80
GN 6220-ST-M8-80-B	M 8	-	-	80	15	14	13	14	90
GN 6220-ST-M10-25-B	M 10	-	-	25	19.5	16	17	16	44
GN 6220-ST-M10-30-B	M 10	-	-	30	19.5	16	17	16	53
GN 6220-ST-M10-35-B	M 10	-	-	35	19.5	16	17	16	63
GN 6220-ST-M10-40-B	M 10	-	-	40	19.5	16	17	16	72
GN 6220-ST-M10-45-B	M 10	-	-	45	19.5	16	17	16	83
GN 6220-ST-M10-50-B	M 10	-	-	50	19.5	16	17	16	72
GN 6220-ST-M10-60-B	M 10	-	-	60	19.5	16	17	16	109
GN 6220-ST-M10-70-B	M 10	-	-	70	19.5	16	17	16	131
GN 6220-ST-M10-80-B	M 10	-	-	80	19.5	16	17	16	151
GN 6220-ST-M10-100-B	M 10	-	-	100	19.5	16	17	16	189

Type A

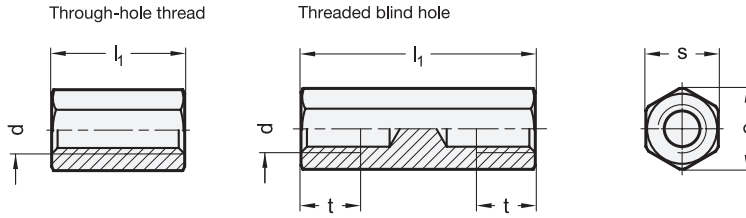

Type B

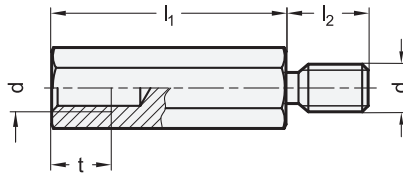

Application example

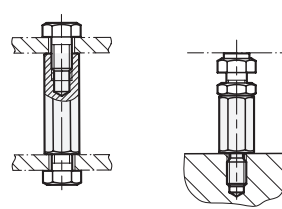

GN 6220-NI

STAINLESS STEEL

Description	d	l1 ±0.1 Through-hole thread	l1 ±0.1 Threaded blind hole	l1 ±0.1	e ≈	l2	s	t min.	⚖
GN 6220-NI-M2.5-5-A	M 2.5	5	-	-	5.8	-	5	7	1
GN 6220-NI-M2.5-8-A	M 2.5	8	-	-	5.8	-	5	7	1
GN 6220-NI-M2.5-10-A	M 2.5	10	-	-	5.8	-	5	7	1
GN 6220-NI-M2.5-12-A	M 2.5	12	-	-	5.8	-	5	7	2
GN 6220-NI-M2.5-15-A	M 2.5	-	15	-	5.8	-	5	7	3
GN 6220-NI-M2.5-20-A	M 2.5	-	20	-	5.8	-	5	7	3
GN 6220-NI-M2.5-25-A	M 2.5	-	25	-	5.8	-	5	7	4
GN 6220-NI-M2.5-30-A	M 2.5	-	30	-	5.8	-	5	7	4
GN 6220-NI-M3-8-A	M 3	8	-	-	6.4	-	5.5	7	1
GN 6220-NI-M3-10-A	M 3	10	-	-	6.4	-	5.5	7	2
GN 6220-NI-M3-12-A	M 3	12	-	-	6.4	-	5.5	7	2
GN 6220-NI-M3-15-A	M 3	-	15	-	6.4	-	5.5	7	2
GN 6220-NI-M3-20-A	M 3	-	20	-	6.4	-	5.5	7	3
GN 6220-NI-M3-25-A	M 3	-	25	-	6.4	-	5.5	7	4
GN 6220-NI-M3-30-A	M 3	-	30	-	6.4	-	5.5	7	5
GN 6220-NI-M3-35-A	M 3	-	35	-	6.4	-	5.5	7	6
GN 6220-NI-M3-40-A	M 3	-	40	-	6.4	-	5.5	7	7
GN 6220-NI-M3-45-A	M 3	-	45	-	6.4	-	5.5	7	8
GN 6220-NI-M3-50-A	M 3	-	50	-	6.4	-	5.5	7	9
GN 6220-NI-M4-10-A	M 4	10	-	-	8	-	7	9	4
GN 6220-NI-M4-12-A	M 4	12	-	-	8	-	7	9	6
GN 6220-NI-M4-15-A	M 4	15	-	-	8	-	7	9	4
GN 6220-NI-M4-20-A	M 4	-	20	-	8	-	7	9	5
GN 6220-NI-M4-25-A	M 4	-	25	-	8	-	7	9	10
GN 6220-NI-M4-30-A	M 4	-	30	-	8	-	7	9	14
GN 6220-NI-M4-35-A	M 4	-	35	-	8	-	7	9	9
GN 6220-NI-M4-40-A	M 4	-	40	-	8	-	7	9	11
GN 6220-NI-M4-45-A	M 4	-	45	-	8	-	7	9	12
GN 6220-NI-M4-50-A	M 4	-	50	-	8	-	7	9	16
GN 6220-NI-M4-60-A	M 4	-	60	-	8	-	7	9	20
GN 6220-NI-M4-70-A	M 4	-	70	-	8	-	7	9	22
GN 6220-NI-M4-80-A	M 4	-	80	-	8	-	7	9	26
GN 6220-NI-M5-20-A	M 5	-	20	-	9.2	-	8	10	10
GN 6220-NI-M5-25-A	M 5	-	25	-	9.2	-	8	10	8
GN 6220-NI-M5-30-A	M 5	-	30	-	9.2	-	8	10	10
GN 6220-NI-M5-35-A	M 5	-	35	-	9.2	-	8	10	14
GN 6220-NI-M5-40-A	M 5	-	40	-	9.2	-	8	10	16
GN 6220-NI-M5-45-A	M 5	-	45	-	9.2	-	8	10	20
GN 6220-NI-M5-50-A	M 5	-	50	-	9.2	-	8	10	18
GN 6220-NI-M5-60-A	M 5	-	60	-	9.2	-	8	10	24

Description	d	l1 ±0.1 Through-hole thread	l1 ±0.1 Threaded blind hole	l1 ±0.1	e ≈	l2	s	t min.	⚖
GN 6220-NI-M5-70-A	M 5	-	70	-	9.2	-	8	10	34
GN 6220-NI-M5-80-A	M 5	-	80	-	9.2	-	8	10	32
GN 6220-NI-M5-12-A	M 5	12	-	-	9.2	-	8	10	6
GN 6220-NI-M5-15-A	M 5	15	-	-	9.2	-	8	10	6
GN 6220-NI-M6-12-A	M 6	12	-	-	11.5	-	10	12	6
GN 6220-NI-M6-15-A	M 6	15	-	-	11.5	-	10	12	7
GN 6220-NI-M6-20-A	M 6	-	20	-	11.5	-	10	10	12
GN 6220-NI-M6-25-A	M 6	-	25	-	11.5	-	10	10	12
GN 6220-NI-M6-30-A	M 6	-	30	-	11.5	-	10	12	16
GN 6220-NI-M6-35-A	M 6	-	35	-	11.5	-	10	12	20
GN 6220-NI-M6-40-A	M 6	-	40	-	11.5	-	10	12	22
GN 6220-NI-M6-45-A	M 6	-	45	-	11.5	-	10	12	26
GN 6220-NI-M6-50-A	M 6	-	50	-	11.5	-	10	12	30
GN 6220-NI-M6-60-A	M 6	-	60	-	11.5	-	10	12	34
GN 6220-NI-M6-70-A	M 6	-	70	-	11.5	-	10	12	41
GN 6220-NI-M6-80-A	M 6	-	80	-	11.5	-	10	12	48
GN 6220-NI-M8-15-A	M 8	15	-	-	15	-	13	14	12
GN 6220-NI-M8-20-A	M 8	20	-	-	15	-	13	14	16
GN 6220-NI-M8-25-A	M 8	-	25	-	15	-	13	12	22
GN 6220-NI-M8-30-A	M 8	-	30	-	15	-	13	14	23
GN 6220-NI-M8-35-A	M 8	-	35	-	15	-	13	14	30
GN 6220-NI-M8-40-A	M 8	-	40	-	15	-	13	14	34
GN 6220-NI-M8-45-A	M 8	-	45	-	15	-	13	14	40
GN 6220-NI-M8-50-A	M 8	-	50	-	15	-	13	14	44
GN 6220-NI-M8-60-A	M 8	-	60	-	15	-	13	14	58
GN 6220-NI-M8-70-A	M 8	-	70	-	15	-	13	14	68
GN 6220-NI-M8-80-A	M 8	-	80	-	15	-	13	14	79
GN 6220-NI-M10-25-A	M 10	25	-	-	19.5	-	17	16	36
GN 6220-NI-M10-30-A	M 10	30	-	-	19.5	-	17	16	42
GN 6220-NI-M10-35-A	M 10	-	35	-	19.5	-	17	16	49
GN 6220-NI-M10-40-A	M 10	-	40	-	19.5	-	17	16	57
GN 6220-NI-M10-45-A	M 10	-	45	-	19.5	-	17	16	66
GN 6220-NI-M10-50-A	M 10	-	50	-	19.5	-	17	16	72
GN 6220-NI-M10-60-A	M 10	-	60	-	19.5	-	17	16	90
GN 6220-NI-M10-70-A	M 10	-	70	-	19.5	-	17	16	111
GN 6220-NI-M10-80-A	M 10	-	80	-	19.5	-	17	16	130
GN 6220-NI-M10-100-A	M 10	-	100	-	19.5	-	17	16	171



Type A

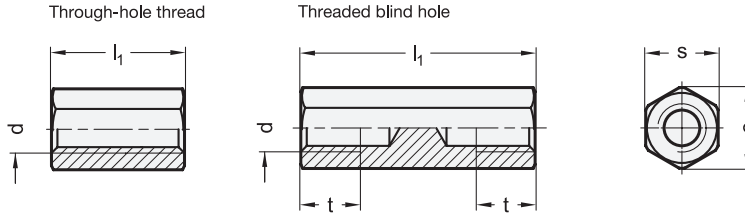

Type B

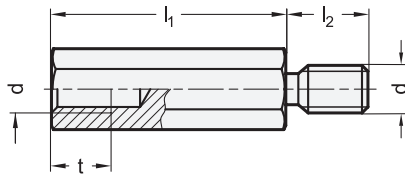

Application example

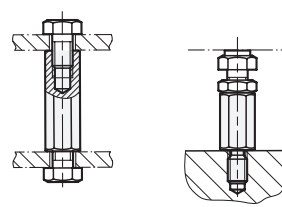

GN 6220-NI

STAINLESS STEEL

Description	d	l1 ±0.1 Through-hole thread	l1 ±0.1 Threaded blind hole	l1 ±0.1	e ≈	l2	s	t min.	△
GN 6220-NI-M2.5-8-B	M 2.5	-	-	8	5.8	6	5	5	1
GN 6220-NI-M2.5-10-B	M 2.5	-	-	10	5.8	6	5	5	2
GN 6220-NI-M2.5-12-B	M 2.5	-	-	12	5.8	6	5	7	2
GN 6220-NI-M2.5-15-B	M 2.5	-	-	15	5.8	6	5	7	3
GN 6220-NI-M2.5-20-B	M 2.5	-	-	20	5.8	6	5	7	3
GN 6220-NI-M2.5-25-B	M 2.5	-	-	25	5.8	6	5	7	4
GN 6220-NI-M2.5-30-B	M 2.5	-	-	30	5.8	6	5	7	5
GN 6220-NI-M3-8-B	M 3	-	-	8	6.4	6	5.5	5	2
GN 6220-NI-M3-10-B	M 3	-	-	10	6.4	6	5.5	5	2
GN 6220-NI-M3-12-B	M 3	-	-	12	6.4	6	5.5	7	2
GN 6220-NI-M3-15-B	M 3	-	-	15	6.4	6	5.5	7	3
GN 6220-NI-M3-20-B	M 3	-	-	20	6.4	6	5.5	7	4
GN 6220-NI-M3-25-B	M 3	-	-	25	6.4	6	5.5	7	5
GN 6220-NI-M3-30-B	M 3	-	-	30	6.4	6	5.5	7	6
GN 6220-NI-M3-35-B	M 3	-	-	35	6.4	6	5.5	7	7
GN 6220-NI-M3-40-B	M 3	-	-	40	6.4	6	5.5	7	8
GN 6220-NI-M3-45-B	M 3	-	-	45	6.4	6	5.5	7	9
GN 6220-NI-M3-50-B	M 3	-	-	50	6.4	6	5.5	7	10
GN 6220-NI-M4-10-B	M 4	-	-	10	8	8	7	5	3
GN 6220-NI-M4-12-B	M 4	-	-	12	8	8	7	7	4
GN 6220-NI-M4-15-B	M 4	-	-	15	8	8	7	9	4
GN 6220-NI-M4-20-B	M 4	-	-	20	8	8	7	9	6
GN 6220-NI-M4-25-B	M 4	-	-	25	8	8	7	9	8
GN 6220-NI-M4-30-B	M 4	-	-	30	8	8	7	9	9
GN 6220-NI-M4-35-B	M 4	-	-	35	8	8	7	9	11
GN 6220-NI-M4-40-B	M 4	-	-	40	8	8	7	9	13
GN 6220-NI-M4-45-B	M 4	-	-	45	8	8	7	9	14
GN 6220-NI-M4-50-B	M 4	-	-	50	8	8	7	9	16
GN 6220-NI-M4-60-B	M 4	-	-	60	8	8	7	9	19
GN 6220-NI-M4-70-B	M 4	-	-	70	8	8	7	9	22
GN 6220-NI-M4-80-B	M 4	-	-	80	8	8	7	9	26
GN 6220-NI-M5-12-B	M 5	-	-	12	9.2	8	8	7	6
GN 6220-NI-M5-15-B	M 5	-	-	15	9.2	8	8	10	6
GN 6220-NI-M5-20-B	M 5	-	-	20	9.2	8	8	10	10
GN 6220-NI-M5-25-B	M 5	-	-	25	9.2	8	8	10	12
GN 6220-NI-M5-30-B	M 5	-	-	30	9.2	8	8	10	12
GN 6220-NI-M5-35-B	M 5	-	-	35	9.2	8	8	10	14
GN 6220-NI-M5-40-B	M 5	-	-	40	9.2	8	8	10	16
GN 6220-NI-M5-45-B	M 5	-	-	45	9.2	8	8	10	18
GN 6220-NI-M5-50-B	M 5	-	-	50	9.2	8	8	10	20

Description	d	l1 ±0.1 Through-hole thread	l1 ±0.1 Threaded blind hole	l1 ±0.1	e ≈	l2	s	t min.	△
GN 6220-NI-M5-60-B	M 5	-	-	60	9.2	8	8	10	25
GN 6220-NI-M5-70-B	M 5	-	-	70	9.2	8	8	10	29
GN 6220-NI-M5-80-B	M 5	-	-	80	9.2	8	8	10	33
GN 6220-NI-M6-15-B	M 6	-	-	15	11.5	10	10	10	10
GN 6220-NI-M6-20-B	M 6	-	-	20	11.5	10	10	12	12
GN 6220-NI-M6-25-B	M 6	-	-	25	11.5	10	10	12	15
GN 6220-NI-M6-30-B	M 6	-	-	30	11.5	10	10	12	22
GN 6220-NI-M6-35-B	M 6	-	-	35	11.5	10	10	12	20
GN 6220-NI-M6-40-B	M 6	-	-	40	11.5	10	10	12	26
GN 6220-NI-M6-45-B	M 6	-	-	45	11.5	10	10	12	30
GN 6220-NI-M6-50-B	M 6	-	-	50	11.5	10	10	12	32
GN 6220-NI-M6-60-B	M 6	-	-	60	11.5	10	10	12	40
GN 6220-NI-M6-70-B	M 6	-	-	70	11.5	10	10	12	46
GN 6220-NI-M6-80-B	M 6	-	-	80	11.5	10	10	12	56
GN 6220-NI-M8-20-B	M 8	-	-	20	15	14	13	14	24
GN 6220-NI-M8-25-B	M 8	-	-	25	15	14	13	14	26
GN 6220-NI-M8-30-B	M 8	-	-	30	15	14	13	14	31
GN 6220-NI-M8-35-B	M 8	-	-	35	15	14	13	14	37
GN 6220-NI-M8-40-B	M 8	-	-	40	15	14	13	14	44
GN 6220-NI-M8-45-B	M 8	-	-	45	15	14	13	14	50
GN 6220-NI-M8-50-B	M 8	-	-	50	15	14	13	14	56
GN 6220-NI-M8-60-B	M 8	-	-	60	15	14	13	14	65
GN 6220-NI-M8-70-B	M 8	-	-	70	15	14	13	14	77
GN 6220-NI-M8-80-B	M 8	-	-	80	15	14	13	14	88
GN 6220-NI-M10-25-B	M 10	-	-	25	19.5	16	17	16	45
GN 6220-NI-M10-30-B	M 10	-	-	30	19.5	16	17	16	55
GN 6220-NI-M10-35-B	M 10	-	-	35	19.5	16	17	16	63
GN 6220-NI-M10-40-B	M 10	-	-	40	19.5	16	17	16	76
GN 6220-NI-M10-45-B	M 10	-	-	45	19.5	16	17	16	83
GN 6220-NI-M10-50-B	M 10	-	-	50	19.5	16	17	16	93
GN 6220-NI-M10-60-B	M 10	-	-	60	19.5	16	17	16	113
GN 6220-NI-M10-70-B	M 10	-	-	70	19.5	16	17	16	132
GN 6220-NI-M10-80-B	M 10	-	-	80	19.5	16	17	16	152
GN 6220-NI-M10-100-B	M 10	-	-	100	19.5	16	17	16	191

Machine elements 9